



Smart Start[®]

Nighty Nite Nature Light[™]

USER'S MANUAL



Dear Parent:

At VTECH® we know that a child has the ability to do great things. That's why all of our electronic learning products are uniquely designed to develop a child's mind and allow them to learn to the best of their ability.

Whether it's introducing numbers and letters, identifying colors and shapes, or stimulating senses with lights and music, all VTECH® infant and toddler learning products encourage your child's natural growth and discovery skills. When it comes to providing electronic learning products that enlighten, entertain and develop minds, at VTECH® we see the potential in every child.

INTRODUCTION

Thank you for purchasing the **VTech® Nighty Nite Nature Light™**! We at **VTech®** are committed to providing the best possible products to entertain and educate your child. Should you have any questions or concerns, please call our Consumer Services Department at 1-800-521-2010 in the U.S. or 1-800-267-7377 in Canada.

The **VTech® Nighty Nite Nature Light™** is a soothing crib light that is designed for babies birth and up. The **VTech® Nighty Nite Nature Light™** uses a combination of classical melodies, nature sound effects, and lights to soothe baby off to dreamland. The **VTech® Nighty Nite Nature Light™** features a built-in sound sensor. If the baby awakes and cries after the product powers-down, the product will automatically re-activate, soothing baby off to dreamland once again.

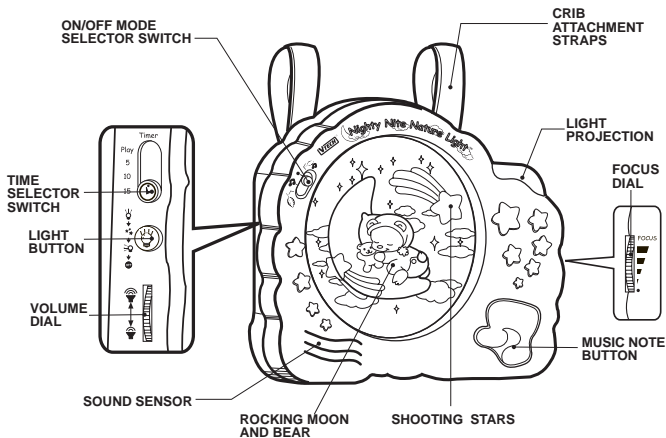

INCLUDED IN THIS PACKAGE

- One VTech® Nighty Nite Nature Light™
- Two crib attachment straps
- One instruction manual

WARNING: All packing materials, such as tape, plastic sheets, wire ties and tags are not part of this toy, and should be discarded for your child's safety.

BATTERY INSTALLATION

1. Make sure the unit is turned **OFF**.



2. Locate the battery cover on the back of the unit. Use a coin or screwdriver to loosen the screw.

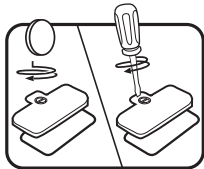

3. Install 4 new “C” size (UM-2/LR14) batteries following the diagram inside the battery box. (The use of new alkaline batteries is recommended for maximum performance.)
4. Replace the battery cover and tighten the screw to secure the battery cover.

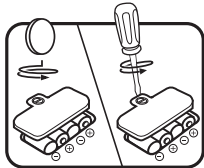

BATTERY NOTICE

- Install batteries correctly observing the polarity (+, -) signs to avoid leakage.
- Do not mix old and new batteries.
- Do not use batteries of different types.
- Remove exhausted or new batteries from the equipment when the unit will not be used for an extended period of time.
- Do not dispose of batteries in fire.
- Do not attempt to recharge ordinary batteries.
- The supply terminals are not to be short-circuited.

WE DO NOT RECOMMEND THE USE OF RECHARGEABLE BATTERIES.

NOTE: If for some reason the program/activity stops working, please follow these steps:

1. Please turn the unit **OFF**.
2. Interrupt the power supply by removing the batteries.
3. Let the unit stand for a few minutes, then replace the batteries.
4. Turn the unit **ON**. The unit should now be ready to play again.

If the problem persists, please call our Consumer Services Department at 1-800-521-2010 in the U.S. or 1-800-267-7377 in Canada, and a service representative will be happy to help you.

LIGHT BULB REPLACEMENT

1. Locate the light bulb cover at the bottom of the unit.

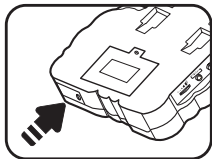

2. Make sure the unit is turned **OFF**. Use a coin or screwdriver to open the cover.



3. Gently pull out the old light bulb and remove the protection ring from the old light bulb.

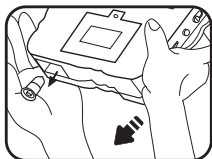

4. Attach the protection ring to the new light bulb. Place the protection ring around the new light bulb and turn the ring until it is securely fastened to the new light bulb. Carefully put the new light bulb into the light bulb socket. Please use a 4.8 volt, 0.3 A light bulb. Please note the maximum power light bulb that can be used is a 2.4 watt light bulb.

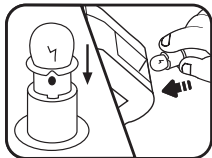

5. Replace the light bulb cover and secure the screw using a coin or screwdriver.

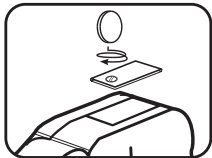

CRIB ATTACHMENT

The crib attachment straps allow for easy and secure mounting of the VTech® Nighty Nite Nature Light™ to a crib.

IMPORTANT NOTE:

To ensure your child's safety, please follow the instructions below carefully and make sure the final assembly is correct. Attach only to cribs with sturdy rails and spindles. Do not attach to playpens with mesh walls.

1. Place the unit in the crib bringing both straps over the top rail. Slip the top of the strap under the slot on the back of the unit and secure. Repeat this procedure for the second strap. You can adjust the hanging height by choosing the appropriate hole on the top of each strap.
2. Pull slightly on the unit to make sure both straps have been securely fastened. The unit should be snugged against the crib rail. Please check the unit frequently to ensure it is still secure.

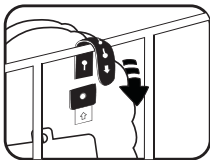

NOTE: For an additional use, the unit can be removed from the crib and placed on a dresser.

TO BEGIN PLAY

1. Slide the **TIME SELECTOR SWITCH** (🕒) to the desired time setting.

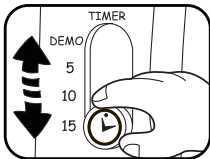

2. Slide the **ON/OFF MODE SELECTOR SWITCH** to the **MELODY MODE** (🎵), **NATURE SOUND EFFECT MODE** (🌿), or **MELODY + NATURE SOUND EFFECT MODE** (🌿 🎵) to turn the unit on.



3. Turn the **VOLUME DIAL** (⬆️ ⬆️) to the desired volume.

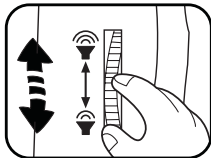

4. Press the **LIGHT BUTTON** (📖) to choose among the 4 light patterns.

- a. Projection light and twinkling star lights (📖)

Note: The projection light and twinkling star lights will automatically turn on when the unit is turned on.

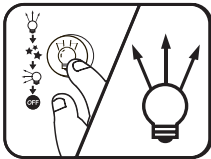

- b. Twinkling star lights (✨).

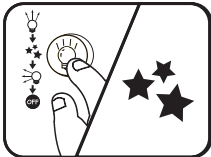

- c. Background light and twinkling star lights ().

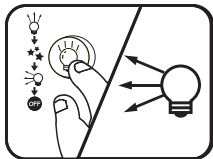

- d. Turn off the lights ().

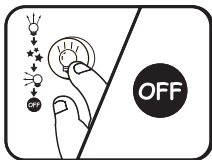

Note: The **FOCUS DIAL** can be used to adjust the projection light. Simply slide the dial to the desired focus while the projection light is on.

5. Press the **MUSIC NOTE BUTTON** () located on the front of the unit to re-activate the selected mode.



NIGHT LIGHT FEATURE

1. While the **ON/OFF MODE SELECTOR SWITCH** is on the **OFF** position, press the **LIGHT BUTTON** () to the desired light setting. The lights will light up according to the time selected.

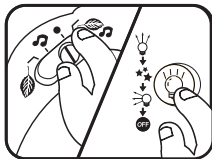

ACTIVITIES

A. Melody Mode

1. Slide the **ON/OFF MODE SELECTOR SWITCH** to the **MELODY MODE** (🎵).

The unit will greet the baby with “It’s lullaby time”. 10 classical melodies will play randomly according to the selected time.



2. The top projection light will light up and the twinkling star lights will flash. The light pattern can be adjusted by pressing the **LIGHT BUTTON** (💡).

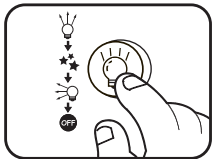

3. Press the **MUSIC NOTE BUTTON** (🎵) to re-activate the mode. “It’s lullaby time” and random classical melodies will begin to play. The lights will light up according to the chosen light pattern.

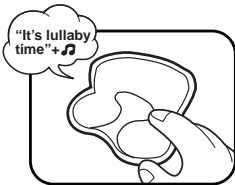



B. Nature Sound Effect Mode

1. Slide the **ON/OFF MODE SELECTOR SWITCH** to the **NATURE SOUND EFFECT MODE** (🌿). This mode will play 5 soothing nature sound effects (wind, wave, rain, bird, cricket). Each sound effect will play for approximately one minute and continue on to the next sound effect. These sound effects will play according to the selected time.

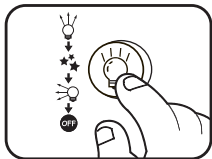

2. The top projection light will light up and the twinkling star lights will flash. The light pattern can be adjusted by pressing the **LIGHT BUTTON** ().



3. Press the **MUSIC NOTE BUTTON** () to re-activate the mode. The 5 soothing nature sounds will begin to play. The lights will light up according to the chosen light pattern.

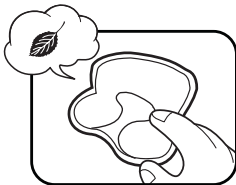



C. Melody + Nature Sound Effect Mode

1. Slide the **ON/OFF MODE SELECTOR SWITCH** to the **MELODY + NATURE SOUND EFFECT MODE** (). The unit will greet the baby with "Nighty Nite". 10 random classical melodies will play along with the 5 soothing nature sounds.

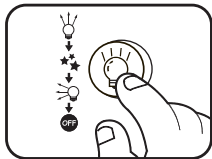

2. The top projection light will light up and the twinkling star lights will flash. The light pattern can be adjusted by pressing the **LIGHT BUTTON** ().



3. Press the **MUSIC NOTE BUTTON** () to re-activate the mode. The unit will greet the baby with “Nighty Nite”. The lights will light up according to the chosen light pattern. Classical melodies and soothing nature sounds will begin to play.



D. Sound Sensor

To extend the soothing atmosphere and sounds, the **VTech® Nighty Nite Nature Light™** has a special sound sensor built within the unit. Once the selected time setting is finished, the product will automatically shut-off. The sound sensor will re-activate the program if background noise is detected for approximately 7 seconds. The unit will re-activate according to the selected mode.

Note: The lights and motor are not activated by the sound sensor.

SOOTHING CLASSICAL MELODIES:

1. Twinkle, Twinkle, Little Star
2. Brahms Lullaby
3. Musetta's Waltz
4. Pachelbel Cannon
5. Air for the G String
6. Largo
7. Swan Lake
8. Moonlight Sonata
9. Artist's Life
10. Clair de Lune

IMPORTANT SAFETY NOTICE:

This criblight is not intended for use as a toy. Please make sure the straps are out of reach from children. When placed in the crib, please make sure the criblight is positioned upright with the projection light facing directly upwards.

CARE AND MAINTENANCE

1. Keep the unit clean by wiping it with a slightly damp cloth.
2. Keep the unit out of direct sunlight and away from any direct heat source.
3. Remove the batteries when the unit is not in use for an extended period of time.
4. Do not drop the unit on hard surfaces and do not expose the unit to moisture or water.

IMPORTANT NOTE

Creating and developing baby products is accompanied by a responsibility that we at **VTech®** take very seriously. We make every effort to ensure the accuracy of the information, which forms the value of our products. However, errors sometimes can occur. It is important for you to know that we stand behind our products and encourage you to call our Consumer Services Department at 1-800-521-2010 in the U.S., or 1-800-267-7377 in Canada with any problems and/or suggestions that you might have. A service representative will be happy to help you.

Note:

This equipment generates and uses radio frequency energy and if not installed and used properly, that is, in strict accordance with the manufacturer's instructions, it may cause interference to radio and television reception. It has been type tested and found to comply within the limits for a Class B computing device in accordance with the specifications in Subpart J of Part 15 FCC Rules, which are designed to provide reasonable protection against such interference in a residential installation. However, there is no guarantee that interference will not occur in a particular installation. If this equipment does cause interference with radio or television reception, which can be determined by turning the equipment off and on, the user is encouraged to try to correct the interference by one or more of the following measures:

- reorient the receiving antenna
- relocate this product with respect to the receiver
- move this product away from the receiver